

Schedule 1

Item 1 Description of Agreement Area

A. External boundary description

The agreement area covers all the land and waters within Lot 5 on CP SM84 [Gunnadoo (aka Cramoisie) Preferential Pastoral Holding] which fall within the external boundary of native title determination application QUD6230/98 Jangga People (QC98/10) as accepted for registration on 19 October 2004.

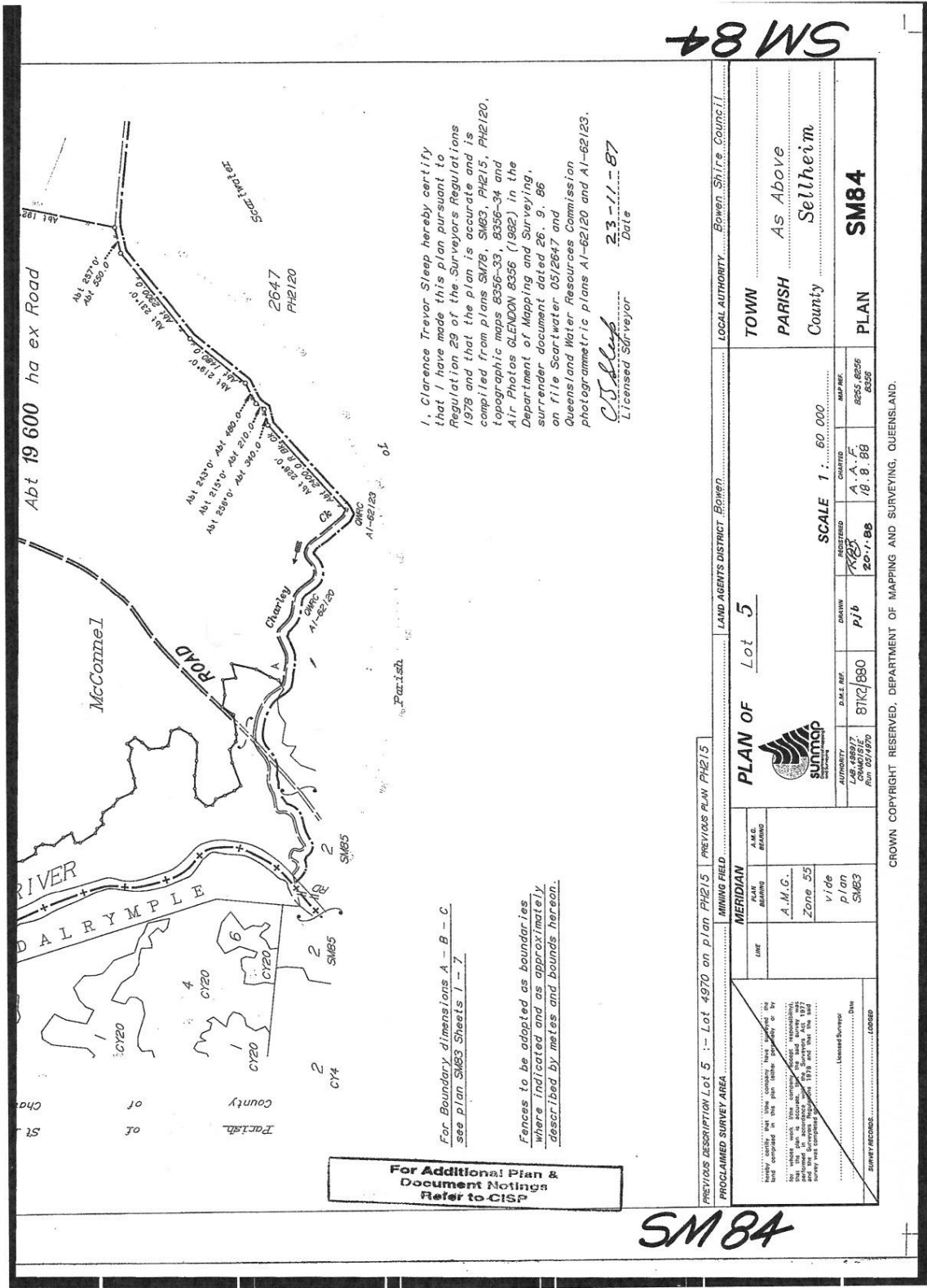

I, Clarence Trevor Sleep hereby certify that I have made this plan pursuant to Regulation 29 of the Surveyors Regulations 1978 and that the plan is accurate and is compiled from plans SM78, SM83, PH215, PH210, topographic maps 8356-33, 8356-34 and Air Photos GLENDON 8356 (1982) in the Department of Mapping and Surveying, Queensland Water Resources Commission on file Scarwater D3/2647 and surrender document dated 26. 9. 86 photogrammetric plans A1-62120 and A1-62123.

C.T. Sleep
 Licensed Surveyor
 23-11-87
 Date

For Boundary dimensions A - B - C see plan SM83 Sheets 1 - 7.

Fences to be adapted as boundaries where indicated and as approximately described by metes and bounds hereon.

For Additional Plan & Document Notings Refer to CISP

SM84

SM84

PREVIOUS DESCRIPTION Lot 5 :- Lot 4970 on plan PH215 PREVIOUS PLAN PH215

PROCLAIMED SURVEY AREA

LAND AGENTS DISTRICT: Bowen	LOCAL AUTHORITY: Bowen Shire Council
MINING FIELD	PLAN OF Lot 5
MERIDIAN	SCALE 1 : 60 000
U.S.G. BEARINGS A.M.G. Zone 55 wide plan SM83	DRAWN PJB D.M.S. REF. 87102680 AUTHORITY L.A. 488917 Date 03/1979
TOWN PARISH As Above County Selthorpe	PLAN SM84

summap
 summap
 summap

REGISTERED 20-1-88
 A.A.F. 18.8.88
 MAP REF. 8255 8256 8356

Survey Records: L00880

CROWN COPYRIGHT RESERVED, DEPARTMENT OF MAPPING AND SURVEYING, QUEENSLAND.

Item 3 Description of Lease

Preferential Pastoral Holding 5/4970 comprising Lot 5 on CP SM84 commonly known as Gunnadoo (aka Cramoisie)

Item 4 Description of Lessee

Central (Qld) Holdings Pty Ltd ACN 011 041 866