

SCHEDULE 1 THE ILUA AREA

PR115255\_01/K.B./Cairns

Land Title Act 1994 ; Land Act 1994  
Form 21 Version 2

SURVEY PLAN

Sheet 1 of 1

PERMANENT MARKS

PM	ORIGIN	BEARING	DIST	NO	TYPE
1-OPM	23a/DP164392	86°08'50"	27.673	137953	New Conn
5-OPM	43/SP233269	348°4'35"	18.09	178972	

REFERENCE MARKS

STN	TO	ORIGIN	BEARING	DIST	
1	O Bolt in Bit	1/DP233217	230°34'15"	5.091	New Conn
1	Nail in Kerb		171°18'	7.221	
1	O Nail in RFP	3a/DP164392	326°43'55"	17.735	
1	O Nail in Kerb	1/DP233217	220°25'	17.993	
2	Nail in Kerb		18°23'	31.19	
3	ONP	3/DP233217	129°00'50"	19.579	
4	Nail in Kerb		218°22'	27.16	New Conn
5	O Nail in Kerb	43/SP233269	159°43'35"	18.067	
6	Nail in Conc		100°44'	36.638	

AHMAT STREET  
O Nail in Kerb  
(23/DP164392)  
O Nail in Kerb  
O Nail in Kerb

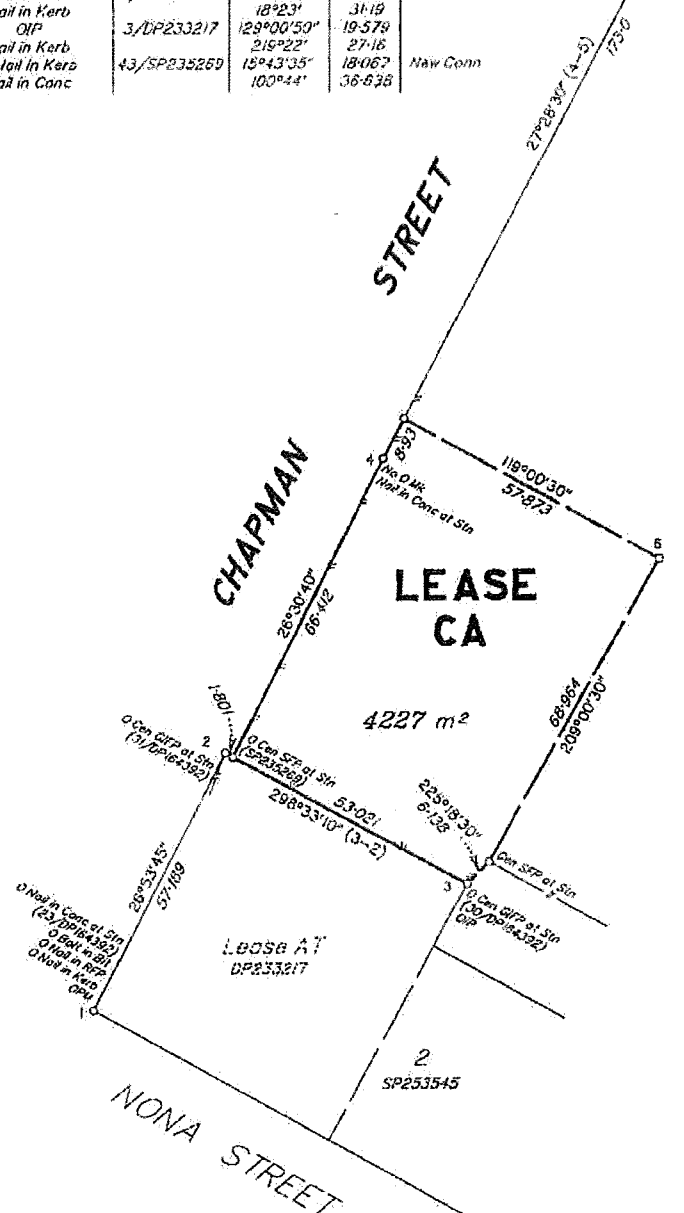
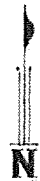

194  
SP253545

Scale 1:1000 - Lengths are in Metres.

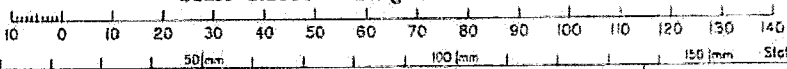

RPS Australia East Pty Ltd (ACN 140 292 752) hereby certify that the land comprised in this plan was surveyed by the corporation, by Darren Kenneth CERTEL, surveying associate, for whose work the corporation accepts responsibility, under the supervision of Aaron Edward SIDLONGH, cadastral surveyor, and that the plan is accurate, that the said survey was performed in accordance with the Survey and Mapping Infrastructure Act 2003 and Surveyors Act 2003 and associated Regulations and Standards and that the said survey was completed on 01/10/2012.

*S. Redgwell*  
Authorised Delegate

30.10.2012  
Date

**Plan of Lease CA**  
in Lot 194 on SP253545

PARISH: **DUNCAN** COUNTY: **Torres**

Meridian: **MGA Zone 54-Vide SP253545** F/N's: **No**

Scale: **1:1000**  
Format: **STANDARD**

**SP256261**

Plan Status: