

Indigenous Land Use Agreement

---

**Schedule 2 –ILUA Area (Clause 5)**

**Written Description**

This Agreement applies to the entirety of Crown Allotment 2037 in the Parish of Hazelwood, as defined in Title Plan 946004D which appears below.

	<b>TITLE PLAN</b>	<b>EDITION 1</b>	<b>TP 946004D</b>
--	-------------------	------------------	-------------------

**LOCATION OF LAND**

PARISH : HAZELWOOD

SECTION :  
CROWN ALLOTMENT : 2036 AND 2037

MGA94 Co-ordinates  
(of approx. centre of land in plan)      E 450150      ZONE: 55  
   N 5765000      GDA 94

DEPTH LIMITATION : 15 Metres

**NOTATIONS:**

SUBJECT TO ANY RESERVATIONS, EXCEPTIONS, CONDITIONS AND POWERS NOTED ON SHEET 4 OF THIS PLAN.

<b>THIS PLAN HAS BEEN PREPARED BY LAND VICTORIA FOR TITLE DIAGRAM PURPOSES.</b>	Checked by: .....
	Date: / /
	Assistant Registrar of Titles

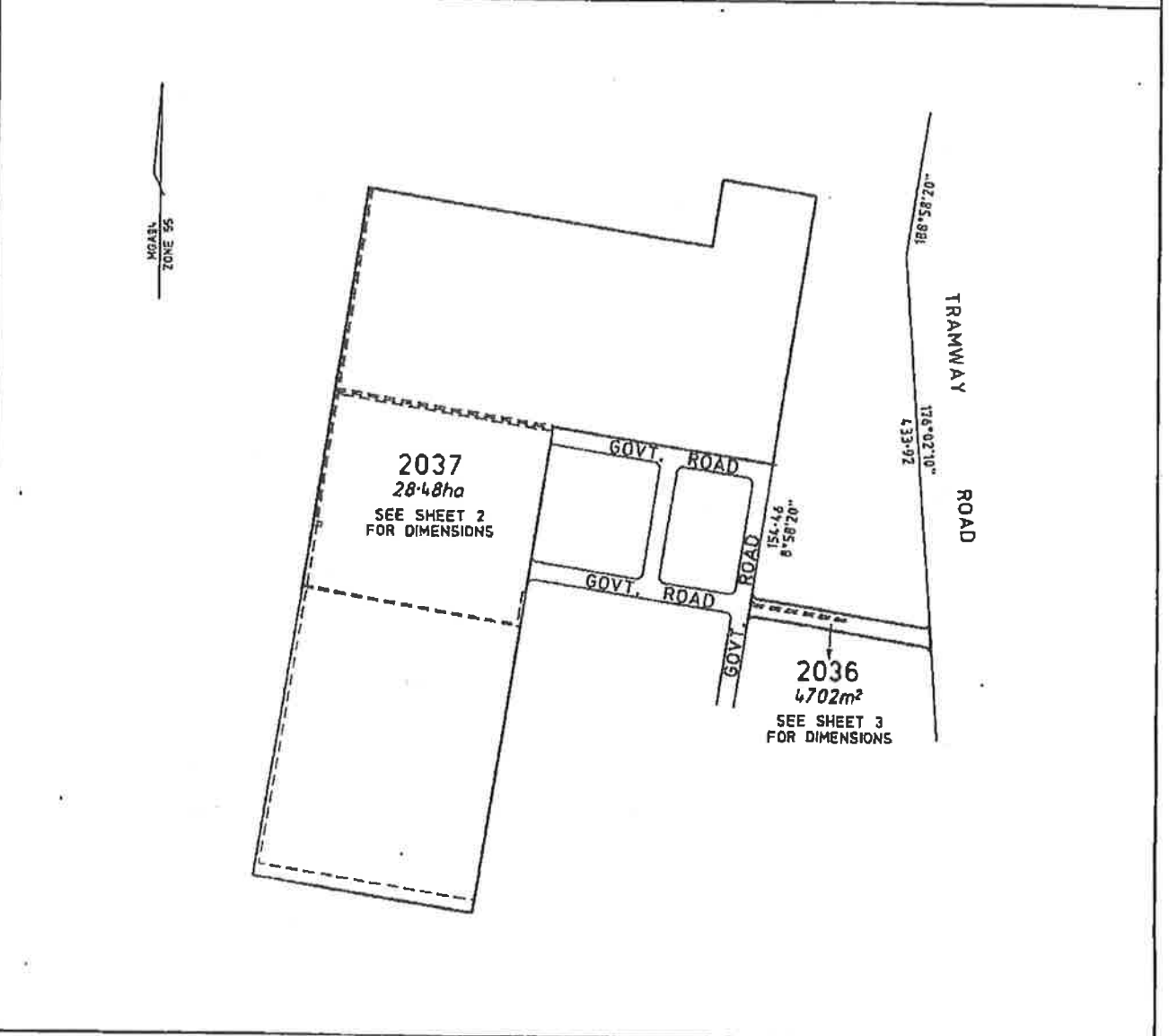

PREPARED FROM: VDP, H120(A4) AND OP123018.

**PLAN OF CROWN ALLOTMENT**

DRAWN: K.T. 08/12/2010  
CAD FILE: TP946004D.DGN

CHECKED: V.CASSAR 20/1/2011

**OFFICE OF SURVEYOR-GENERAL VICTORIA**  
DEPARTMENT OF SUSTAINABILITY AND ENVIRONMENT

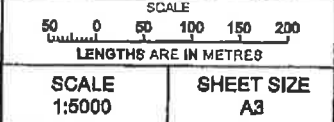

*John E. Jullough*      11.1.2011  
SURVEYOR-GENERAL      DATE

File Ref. F2003/01035	Sheet 1 of 4 Sheets
-----------------------	---------------------

TITLE PLAN

EDITION 1

TP 946004D

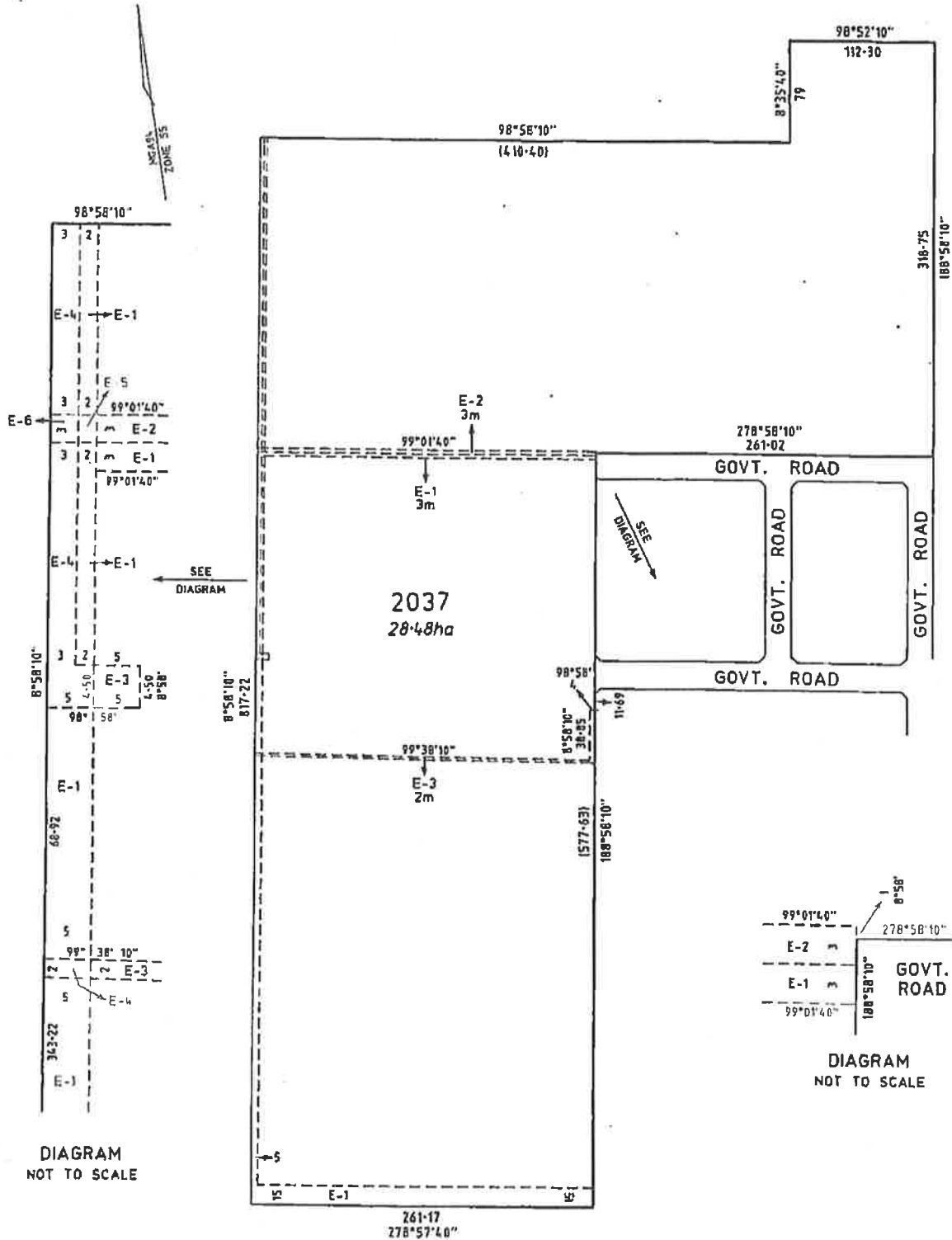

OFFICE OF  
SURVEYOR-GENERAL VICTORIA  
DEPARTMENT OF SUSTAINABILITY  
AND ENVIRONMENT



SCALE  
1:3000

SHEET SIZE  
A3

*John E. Fulloch*  
SURVEYOR-GENERAL

11. 1. 2011  
DATE

File Ref. F2003/01035

Sheet 2 of 4 Sheets

TITLE PLAN

EDITION 1

TP 946004D

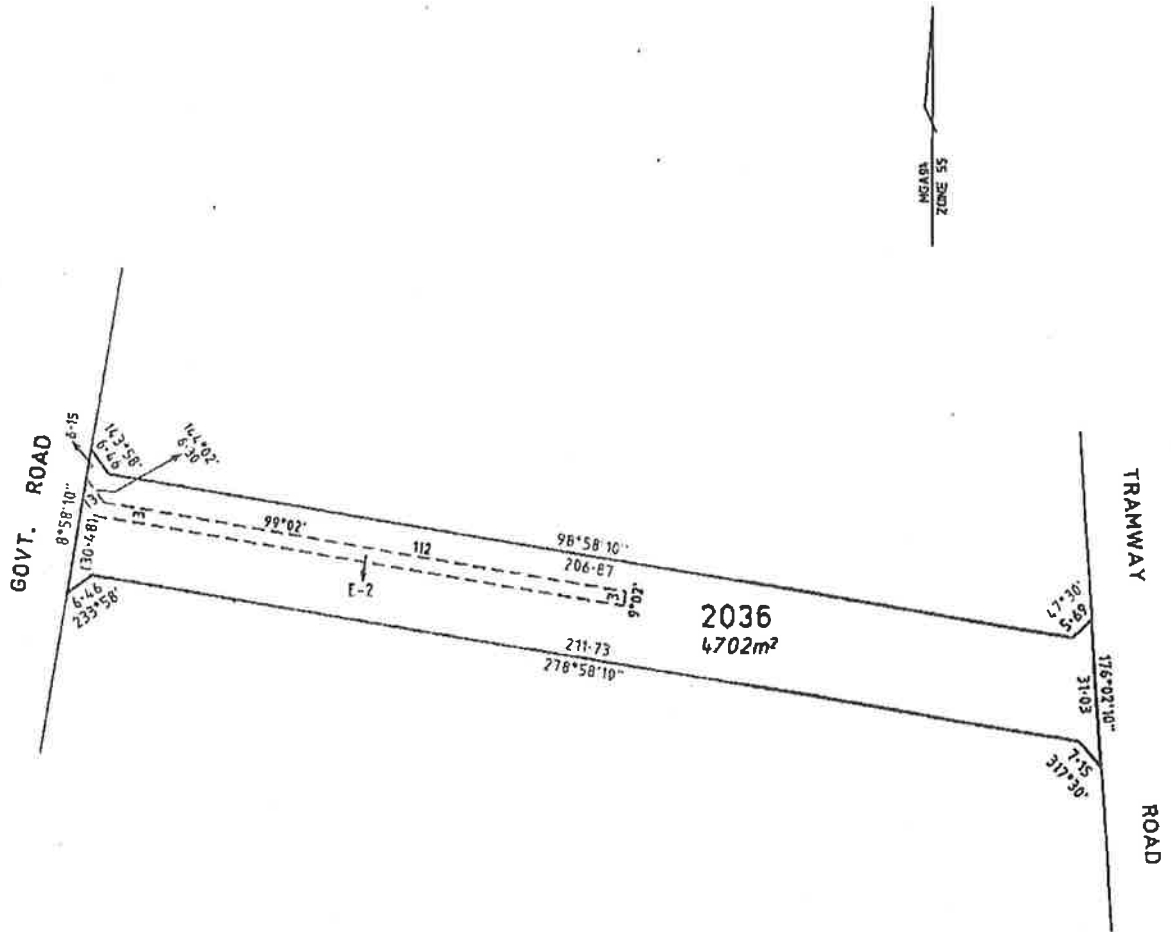

OFFICE OF  
SURVEYOR-GENERAL VICTORIA  
DEPARTMENT OF SUSTAINABILITY  
AND ENVIRONMENT

SCALE  
10 0 10 20 30 40  
LENGTHS ARE IN METRES

SCALE  
1:1000

SHEET SIZE  
A3

*John E. Jullott*  
SURVEYOR-GENERAL

11. 1. 2011  
DATE

File Ref. F2003/01035

Sheet 3 of 4 Sheets

# TITLE PLAN

# TP 946004D

## RESERVATIONS EXCEPTIONS CONDITIONS AND POWERS

The reservation to the Crown of:

- any minerals as defined in the *Mineral Resources (Sustainable Development) Act 1990* and petroleum as defined in the *Petroleum Act 1958* (the "reserved minerals");
- rights of access to any part of the land to search and obtain the reserved minerals; and
- rights of access to any part of the land for pipe-lines, works and other purposes necessary to obtain and convey the reserved minerals on and from the land;

The right to resume the said land for mining purposes under Section 205 of the *Land Act 1958*; and

The right of a licensee under the *Mineral Resources (Sustainable Development) Act 1990* or any corresponding previous enactment, to enter land and do work, within the meaning of that Act, and to erect and occupy mining plant or machinery on the land, in the same manner and under the same conditions and provisions as such licensee currently has on Crown land, provided compensation is paid under Part 8 of that Act for surface damage to the lands.

The right of the Municipal or other Authority or body for the time being concerned with the control and management of public or municipal watercourses or drains in the vicinity of the land hereby granted and its officers agents servants contractors and workmen to cut make and construct and from time to time use maintain repair cleanse and enlarge a drain for the purpose of conveying surface and other waters from any adjoining or adjacent land upon over under and along that portion of the land hereby granted shown marked E-1, E-4, E-5 and E-6 in the said map.

The full and free right and liberty of any authority or authorities of Our said State empowered or authorised to make manage or maintain any sewer or sewers and its or their agents officers workmen servants and contractors at all times hereafter to make cut construct use maintain and repair as such authority or authorities may deem necessary or desirable all drains sewers and other like works upon over along or under that portion of the land hereby granted shown marked E-2, E-5 and E-6 in the said map.

The right of the Municipal or other Authority having the management or control of water supply in the vicinity of the land hereby granted and its officers agents servants contractors and workmen to cut make and construct and from time to time use maintain and repair a pipe line or channel for the purpose of conveying water in upon over under and along that portion of the land hereby granted shown marked E-3, E-4 and E-6 in the said map.